



**G.P.T CO**  
Gol Pump Technology Company

GOCUT Series, these cutter pumps are designed for handling raw sewage and for various wastewater treatments. The cutting mechanism consists of a chopper plate and a tungsten carbide alloy tipped onto each vane of the semi-open channel impeller.

The device shreds fibrous materials into small pieces to prevent from clogging.

**60Hz**

**Sewage Pump**

**GOCUT 315**

Cutter Pump





**G.P.T CO**

www.golpumps.com  
www.golpumps.us

Hz 60

## GOCUT 315

Cutter Pump

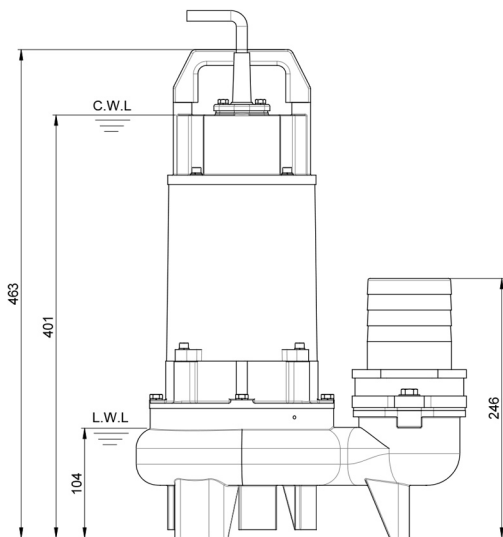
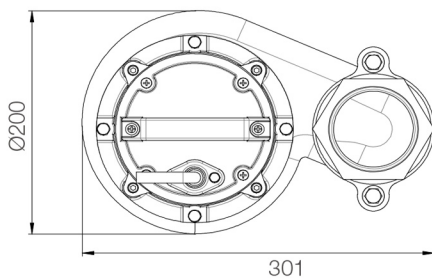

unit : mm

Weight : 27kg / 60 lbs

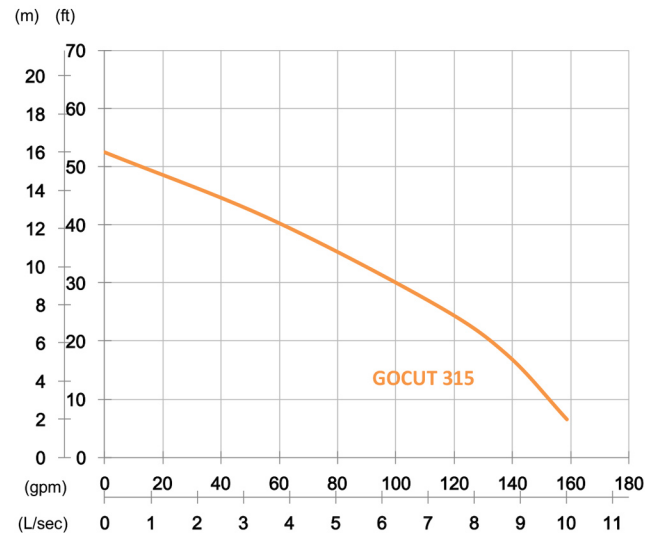

Shaft Speed : 3450 rpm

Outlet : 80mm, 3in

OUTPUT	HEAD	FLOW
1.5 kW	Rated : 8m, 26ft	Rated : 7.2 L/s, 114 gpm
2 HP	Max : 16m, 52ft	Max : 10 L/s, 159 gpm

Solid Passage : 27mm, 1.1in

Pump Type		Electric Submersible Pumps
		1-Phase, 3-Phase
Motor	Type	Induction Motor
	Poles	2 Pole
	Insulation	Class F
	Protector	Circle Thermal Protector
Lubricant	Starter	1-Phase · Capacitor-Run, 3-Phase · D.O.L.
	Food Grade (ISO VG32)	
	Semi-Open Channel Cutter	
	Double Mechanical Seal	
Shaft Seal	Silicon Carbide VS Ceramic / Carbon	
	C3 Shielded ball bearings	
Cable	PVC (CSA Certified) / H07RN-F	
	6m (20ft) or longer upon request.	
Materials	Pump Casing	Gray Iron
	Impeller	Gray Iron
	Motor Frame	Gray Iron
	Motor Shaft	Stainless Steel
Max. Liquid Temperature		40°C (104°F)
Max. Submersion Depth		20m (66ft)
pH Range		pH 5 - pH 8
Guide Rail		GRL-03F